

PERFORMANCE MECHANICAL

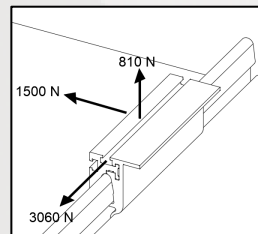

MATERIAL

Bracket: Aluminum alloy 6060 T6
Screws: AISI 304 A2 stainless steel

COMPONENTS

- n.1 male extruded profile L=150mm
- n.1 female extruded profile L=150mm
- n.2 M8 special screws

NOTES

- The declared strength values have been calculated considering a safety coefficient of 1.5 on the failure value s obtained from the tests.
- Tests were performed using 5754 aluminum sheets with a nominal thickness of 0.7 mm.
- The tests were performed using a slab span with 1.2 m supports and the SKA103 was installed in the center (worst case).
- The bracket can be installed in any position, even near the SKA201 polyamide bracket, without affecting the free thermal flow of the sheets.
- Do not install the bracket beyond the last SKA201 bracket.
- It is mandatory to use silicone (6 cubic centimeters) on the interlocking drawer in phase 2.
- The bracket must be installed according to the design carried out by an experienced technician.
- SkyProof Company will not be responsible in case of incorrect design or installation.

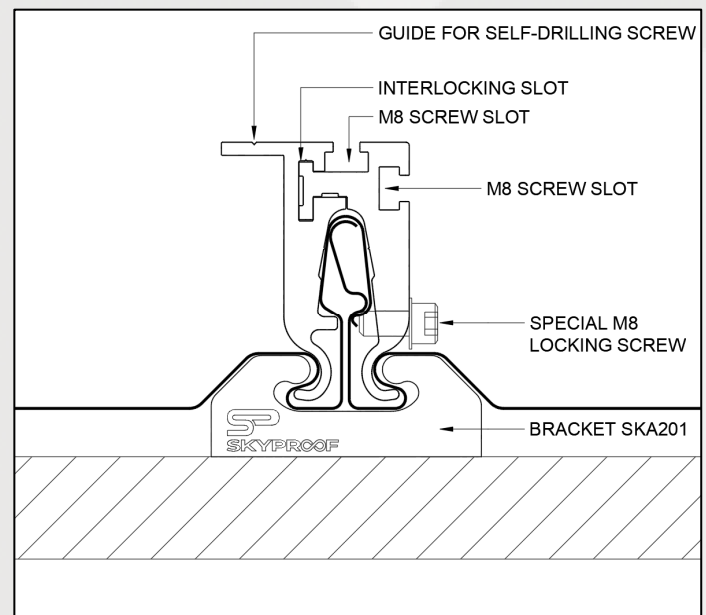

ASSEMBLY PROCEDURE

